

VALUE Wireless Audio/Video System, HDMI, 20 m

Manual

14.99.3414

Product information is subject to change without prior notice.

About

Transmitter

Easily mirror whatever is shown on your laptop or mobile screen, ideal for watching videos, gaming and so on.

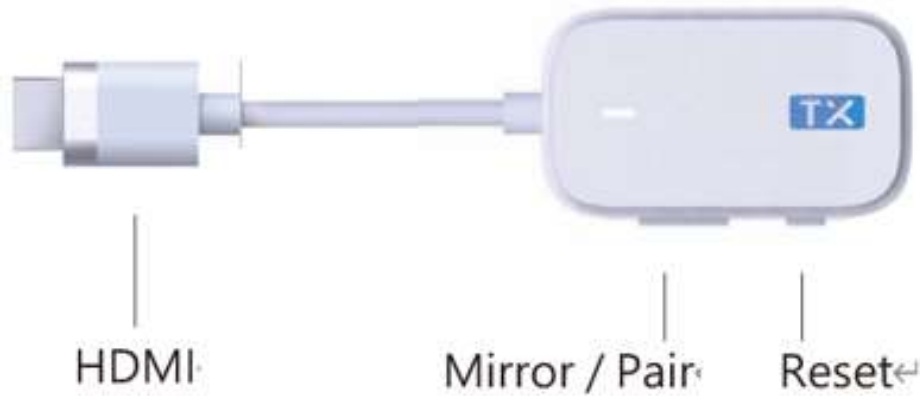

Receiver

Displays the content passed from your transmitter to the monitor.

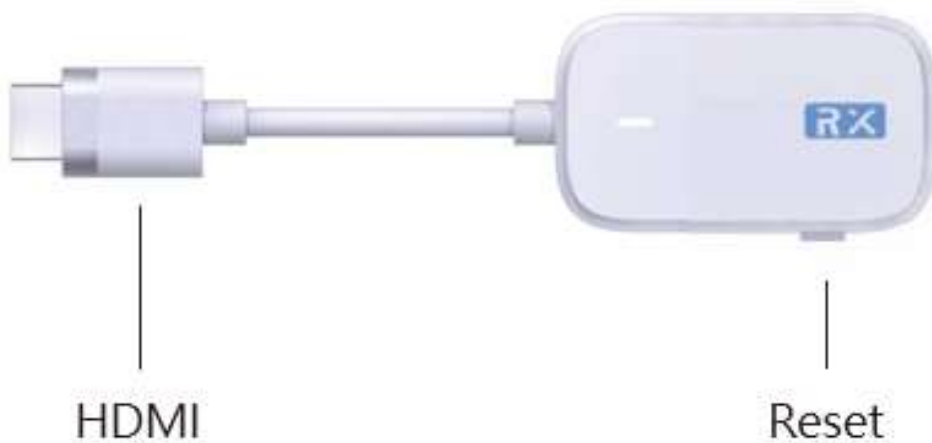

How to mirror

1 Install the receiver

Connect the Receiver to the HDMI port on the monitor, and power on by an independent power 5V/1A adapter.

2 Plug and play

Plug the Transmitter to the HDMI port on the notebook. Wait a few seconds until the flashing light on the transmitter stops, and it will start mirroring automatically. Use the Type-C slot to connect to an independent power 5V/1A adapter.



3 Stop and restart mirroring

Press the mirror / pair button on the transmitter to stop mirroring or restart mirroring.

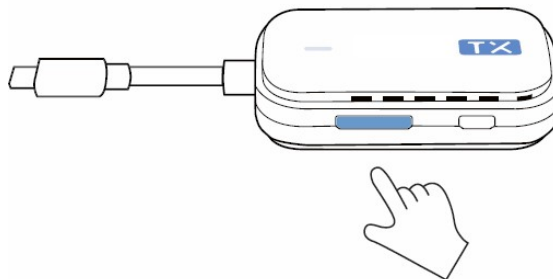

How to pair the transmitter with the receiver

1 Turn on pairing mode for the receiver

- (1) Power up the receiver by an external adapter (5V/1A).
- (2) Plug the receiver to the HDMI port on the monitor.
- (3) Press the reset button on the receiver for 2 seconds. Release when the screen shows "Release the button to pair" .

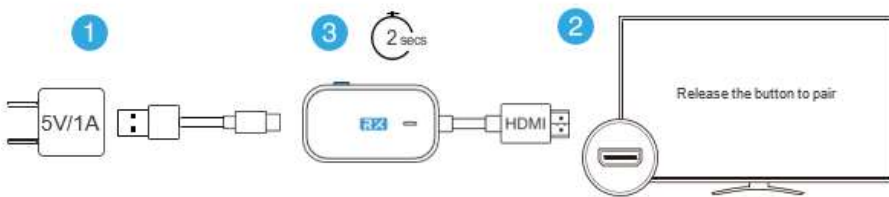

2 Press the mirror / pair button on the transmitter

Plug the transmitter on the laptop. Please make sure to use the Type-C connector to provide power. Press the mirror / pair button on the transmitter for 5 seconds to complete pairing while the screen shows "Ready to pair" . After paired, it will start casting automatically.



Note : There are 2 modes for the reset button on the Receiver, depending on the pressing duration.

- (1) Press for 2 seconds: Turn on pairing mode for the Transmitter.
- (2) Press for 10 seconds: Reset the Receiver to default.