



Datenblatt - Fiche technique - Data sheet

21.88.2182



ROLINE GOLD S/FTP-(PiMF-) Patchkabel Kat.6A, 2,0 m

Cordon ROLINE GOLD Cat.6A S/FTP (PiMF), 2,0 m

ROLINE GOLD S/FTP Patch Cord Cat.6A, 2.0 m

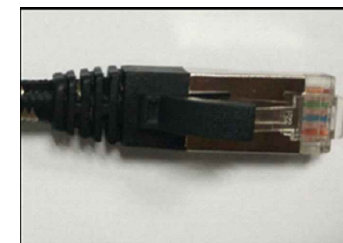
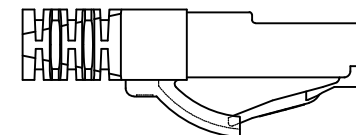
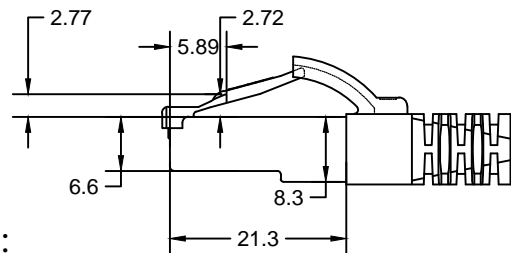
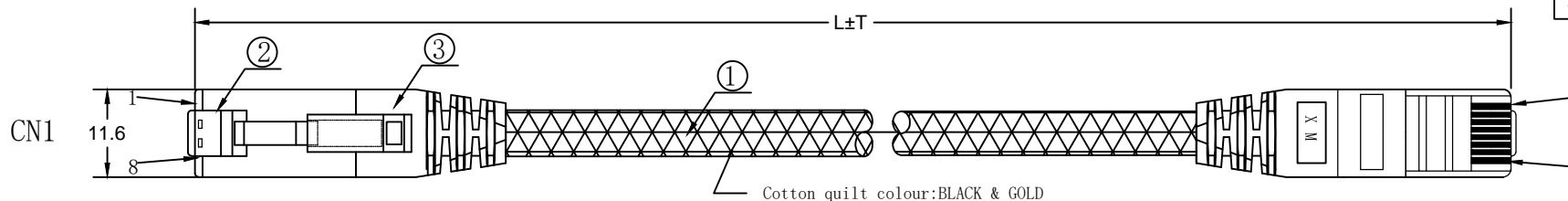

NOTE:

1. ELECTRICAL TEST:

- (1). 100% OPEN SHORT, MISS WIRE TEST
- (2). INSULATION RESISTANCE:DC 300V 10MΩ ;
- (3). CONDUCTOR RESISTANCE:3Ω Max (More than 3m, add one ohm per meter) ;

2. Fluke channel link test:

TEST LIMIT:ISO11801 Channel Class Ea

3. PRINT WORD:

CAT.6A S/FTP LSZH 500MHz ISO/IEC 11801 & EN 50173-1 & ANSI/TIA-568-C.2

4. ROHS2.0 & REACH COMPLIANT

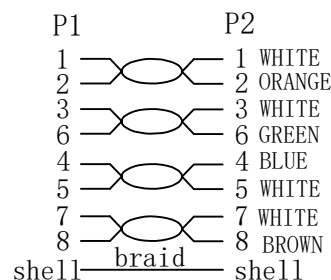

MATERIAL LIST

③	OVER MOLD	PVC 75A BLACK.	2	
②	CONNECTOR	RJ45 8P8C Shielded Plug, Pin Gold Plated 3u", Shell Gold Plating Transparence	2	
①	CABLE	S/FTP CAT. 6A 27AWG (7/0.13BC*1P+AL-FOIL)*4PAIRS+BRAID(5*16/0.12mmAL-MG) JACKET:LSZH OD:6.0±0.2mm, BLACK & GOLD Cotton Braiding OD:6.5±0.2mm	1	
NO.	PARTS NAME	SPECIFICATION STANDARD	QT' Y	REMARK
		NEW		2015-10-21
BY	CHK	REVISION RECORD MODIFICATION	DATE	REV.

COLOUR:BLACK & GOLD		
ITEM NO.	LENGTH(L)	TOLERANCE(T)
21. 15. 2180	0.5m	±15mm
21. 15. 2181	1m	±30mm
21. 15. 2182	2m	±60mm
21. 15. 2183	3m	±90mm
21. 15. 2185	5m	±150mm
21. 15. 2186	7m	±210mm
21. 15. 2187	10m	±300mm
21. 15. 2188	15m	±450mm
21. 15. 2189	20m	±600mm

ITEM NO.	21. 15. 2180	21. 15. 2181	21. 15. 2182	21. 15. 2183	21. 15. 2185
	21. 15. 2186	21. 15. 2187	21. 15. 2188	21. 15. 2189	
DESC.	ROLINE GOLD SFTP CAT.6A Patch Cord With BLACK & GOLD Cotton Braiding				

