



Secual Box

Quick start guide

www.etiger.com

Only if you are using a SIM card

1

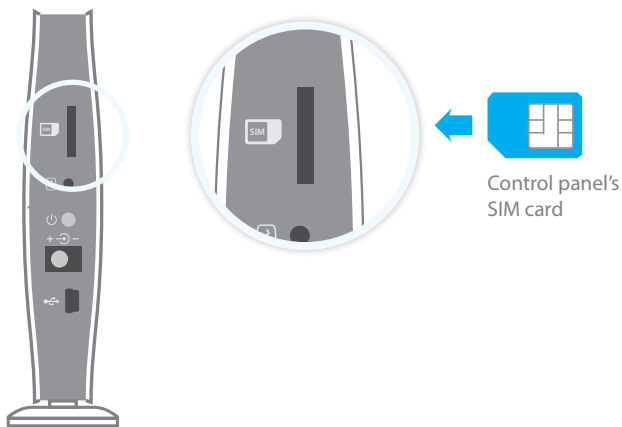

Insert the SIM card in the control panel

You will need a SIM card if you wish to interact with your Secual Box by SMS and phone calls.

Important

- Make sure the SIM card is not protected by a PIN code.
- We advise you to choose a plan with unlimited text and 1 or 2 hours of call. The SIM card must be compatible with the GSM network. Contact your carrier for more information.



2

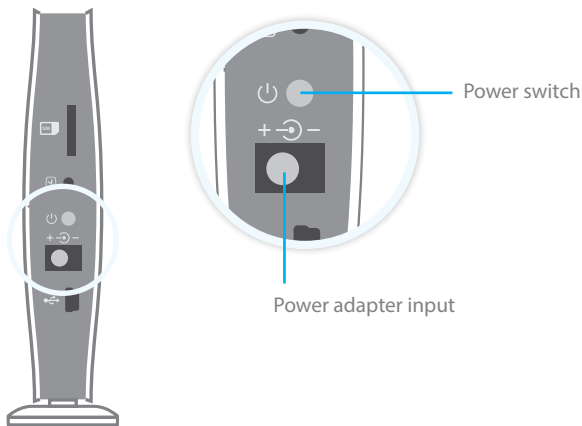

Turn the control panel on

1. Plug the power adapter to an AC socket.
2. Plug the output connector of the power adapter into the adapter input on the side of your control panel.
3. Push the power switch.

3

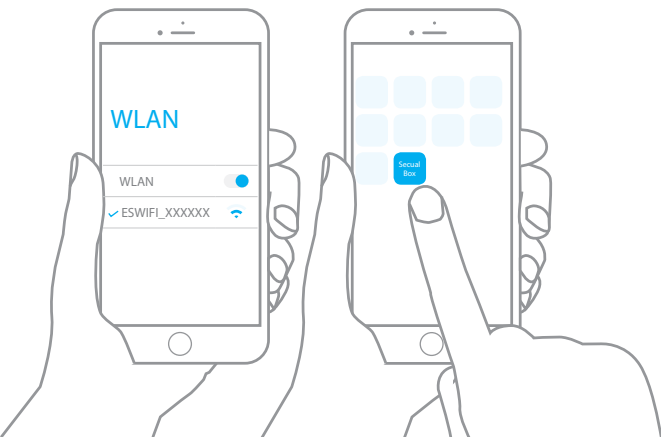

Get your app ready

1. Download the "Secual Box" app on your smartphone (on the App Store and Google Play).
2. Open the "Secual Box" app on your smartphone.

"SIM card only" users

If you are using the Secual Box with a SIM card and cannot use the iOS and Android apps, read the full manual to learn more about interaction by SMS and phone call.

Full manual is available on etiger.com



Accessories

Motion detector

We recommend to mount the detector at a height of 2.2m. The detector does not detect animals under 25 kg. Avoid mounting the detectors in areas with a large amount of metal or electrical devices.

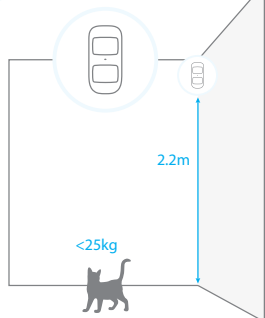

Understanding the standby mode

If the detector is triggered more than twice within 3 minutes, it switches to standby mode to save power. During standby mode, the detector is inactive. If within the next 3 minutes a new movement is detected, the standby mode is extended by 3 minutes. If no movement is detected within the next 3 minutes, the sensor is activated again.



Door contacts

Mount the magnet with double-sided tape on the door and the door frame respectively.

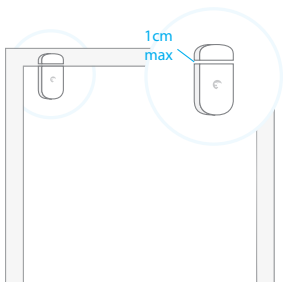

Advanced settings

Connect more accessories

Additional accessories can be connected from the app, in the settings of your control panel. Or you can press the “” button on the side of your control panel, and trigger the accessory. You hear one beep: the accessory is registered. If the control panel beeps twice, the accessory was already connected.

Control by phone call (SIM card required)

Your alarm system can be controlled and monitored by phone call. For more information on the control by phone call, read the full manual on etiger.com

Full manual

For more settings, please refer to the user manual of the control panel, available for download on etiger.com



Precautions



ATTENTION
RISK OF ELECTRIC
SHOCK
DO NOT OPEN



CAUTION: TO REDUCE THE RISK OF ELECTRIC SHOCK, DO NOT REMOVE COVER (OR BACK). NO USER SERVICEABLE PARTS INSIDE, REFER SERVICING TO QUALIFIED SERVICE PERSONNEL.



This symbol is intended to alert the user to the presence of uninsulated “dangerous voltage” within the product’s enclosure that may be of sufficient magnitude to constitute a risk of electric shock to persons.



The exclamation point within an equilateral triangle is intended to alert the user to the presence of important operating and maintenance (servicing) instructions in the literature accompanying the product.

To prevent fire or shock hazards, do not expose this product to rain or moisture. Apparatus shall not be exposed to dripping or splashing and no object filled with liquids, such as vases, shall be placed on the apparatus.

Standards



This product bears the selective sorting symbol for waste electrical and electronic equipment (WEEE). This means that this product must be handled pursuant to European Directive 2002/96/EC in order to be recycled or dismantled to minimize its impact on the environment. For further information, please contact your local or regional authorities. Electronic products not included in the selective sorting process are potentially dangerous for the environment and human health due to the presence of hazardous substances.



In compliance with European laws. This product is in compliance with the essential requirements and other relevant provisions of Directive 1999/5/EC.



This product was designed and manufactured in compliance with Directive 2002/95/EC of the European Parliament and of the Council on the restriction of use of certain hazardous substances in electrical and electronic equipment (RoHS Directive - RoHS) and is deemed to comply with the maximum concentration values set by the European Technical Adaptation Committee (TAC).

Manufactured in China.



Images, illustrations and text are non-contractual. eTIGER and the eTIGER logo are registered trademarks and the property of eTIGER. Copyright © 2016 eTIGER. All rights reserved.



eTIGER EUROPE

18/C, Rue des Procureurs, 7500 Tournai, Belgium

service@etiger.com