

INTRODUCTION

The AW-FGT-100B is an 8 port 10/100BaseT unmanaged PoE switch capable of feeding 15.4/30W (56V max. per port) power to Power over Ethernet (PoE) devices. The device comes with another 2 GbE uplink ports. The switch is capable of a total of 120 Watts power budget.

PACKAGE CONTENTS

* 1x PoE switch	* 1x Quick Installation Guide
* 2x rack mount ears	* 1x power cord (type by the shipped-to area)

⚠ IMPORTANT:

1. Install the PoE switch in a ventilated and dry place that is free of electromagnetic source, vibration, moisture, and dust.
2. Make sure the ventilation openings on the switch are not blocked.
3. Use CAT5 or 6 UTP/STP cables.
4. AC input (100~240V/AC, 50~60Hz), for a max. consumption of 120W.

CONNECTION

Front Panel



Rear Panel

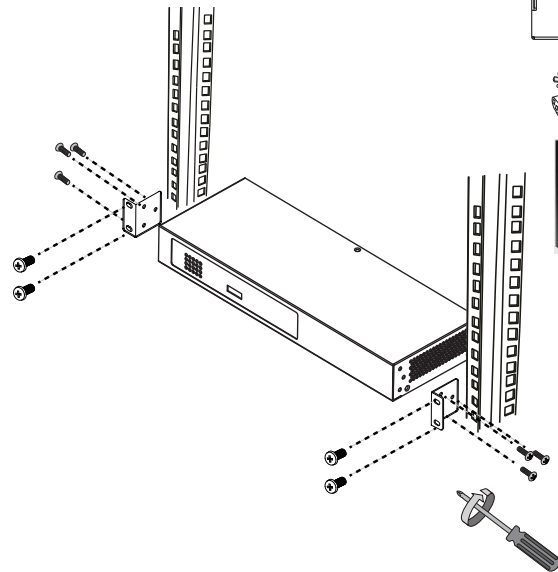
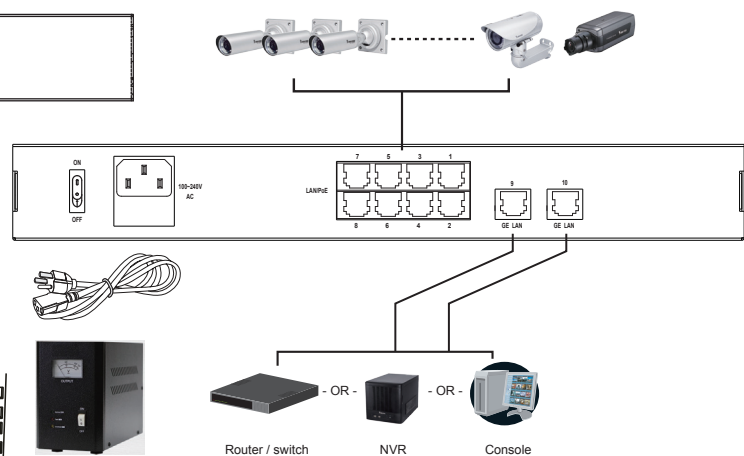

LED DEFINITIONS

POWER	Green ON	Power is on and normal.
	Green Off	Power is off.
GbE	Green ON	Ethernet is connected and operating at 1000Mb.
	Green Flashing	Data is being transmitted or received.
	Yellow ON	Ethernet port is connected and operating at 10/100Mb.
	Yellow Flashing	Data is being transmitted or received.
10/100M (LAN)	Green ON	Ethernet port is connected and operating at 100Mb.
	Green Flashing	Data is being transmitted or received.
	Off	No connection.
PoE	Yellow ON	Port is linked to a powered device.
	OFF	No device is connected.

All specifications are subject to change without notice.
Copyright © 2014 VIVOTEK INC. All rights reserved.